

PERDHESA, SIP: 111.7 m²

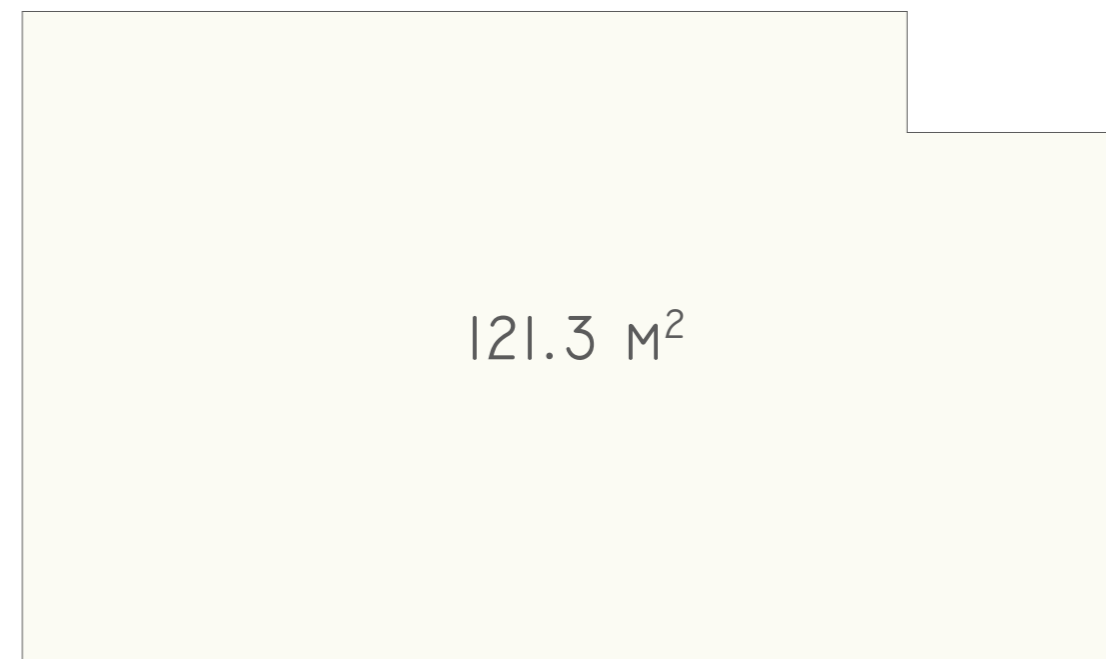

SUTERENI -I, SIP: 121.3 m²



SUTERENI -2 , SIP:85.1 m²

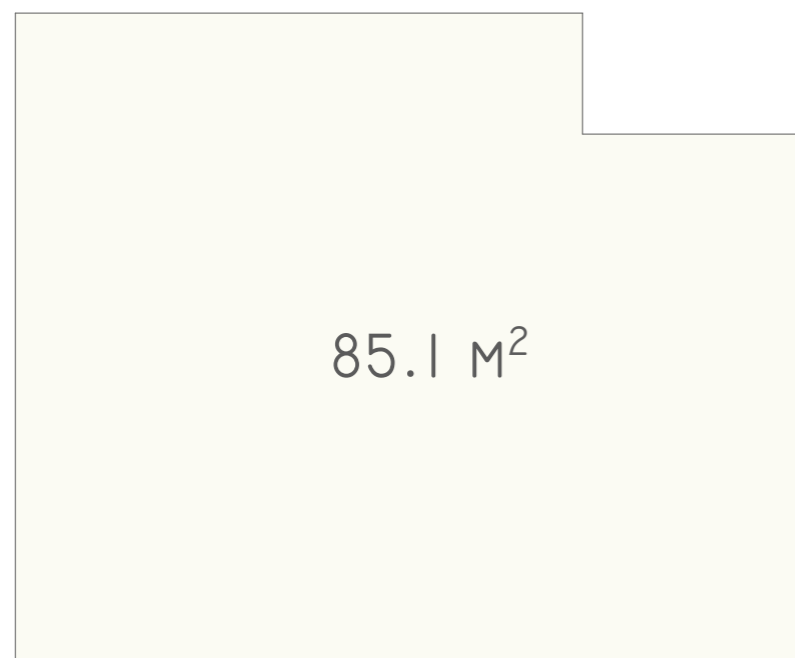

TIPI 3

PËRDHESA, SIP: 111.71m²

SUTERENI -I, SIP: 121.27m²

SUTERENI -2, SIP: 85.15m²

TOTAL: 318.13m²

 VIZION PROJECT <small>PROJECTS, CONSTRUCTION, CONSULTING, GIS, ENGINEERING</small>	PROJEKTOI: PROJECTED BY:	INVESTITORI: INVESTOR:	KABASHI INVEST SH.P.K		
	OBJEKTI: BUILDING:	LAGJE BANIMI-BERNICA 9 "TIPI 3"			
	VENDI I NDËRTIMIT: LOCATION:	BERNICË E EPËRME - PRISHTINË, P 34			
	PROJEKTUES: PROJECT DESIGN:	SHKELQIM OSMANI, IDA			
	FAZA: PHASE:	PROJEKTI KRYESORE / ARKITEKTURA			
EMRI I FLETËS: SHEET NAME:	SIPERFAQJA BRUTO				
FORMATI: PAPER SIZE:	A3	PERPJESA: SCALE:	DATA: DATE:	2024	A-15